

THE STOKE-ON-TRENT CITY COUNCIL (GRANGE CANAL BRIDGE) SCHEME 2020

The Stoke-on-Trent City Council ("the Council") make this Scheme in exercise of their powers under section 106(3) of the Highways Act 1980 and of all other powers enabling them in that behalf.

1. The Council are authorised to construct over the navigable waters of the Trent and Mersey Canal the bridge specified in the Schedule to this Scheme as part of the highway they are proposing to construct from the eastern roundabout off the A500 Wolstanton Junction to Festival Way in the District of Etruria in the City of Stoke-on-Trent and in Newcastle-under-Lyme in the County of Staffordshire.

2. The Scheme may be cited as The Stoke-on-Trent City Council (Grange Canal Bridge Canal) Scheme 2020.

Given under the Common Seal of the Stoke-on-Trent City Council on the 10th NOVEMBER 2020

THE COMMON SEAL of the Stoke-on-Trent City Council was hereunto affixed in the presence of:

W. Beckett

Authorised Signatory (Officer).



THE SCHEDULE TO THE SCHEME

Plans and Specifications of the Grange Canal Bridge.

The location and general design of the Bridge are shown on plans numbered 70058503/ODBO/0001 and 70058503/ODBO/0002 and marked "The Stoke-on-Trent City Council (Grange Canal Bridge) Scheme 2020"

Points of Commencement and Termination: The Grange Canal Bridge is 556 metres east of the mid-point of A500 Wolstanton underpass and 136 metres west of Festival Way

Span: Skew Span approximately 27 metres.

Headway: Required headway 2.7 metres over towpath. Headway provided is not less than 3 metres to any part of the Canal or Towpath.

Waterway: The current minimum square width of the Canal beneath the Bridge is approximately 13.5 metres.

Overall Dimensions: The Bridge will be 15.8 metres wide overall and will carry a 7.3 metres wide carriageway. There will be a 2.5 metres minimum wide raised hard verge on the north of the Bridge and a 3.7 metres wide combined footway and cycleway on the south of the Bridge.

THE STOKE-ON-TRENT CITY COUNCIL (GRANGE CANAL BRIDGE) SCHEME 2020

ORDERS UNDER SECTION 106 OF THE
HIGHWAYS ACT 1980

PLAN NOTES

SCALE 1:1250

THE STOKE-ON-TRENT CITY COUNCIL
(GRANGE CANAL BRIDGE) SCHEME 2020

Drawing No. 70058503/0D50/0001

BRIDGE LOCATION PLAN

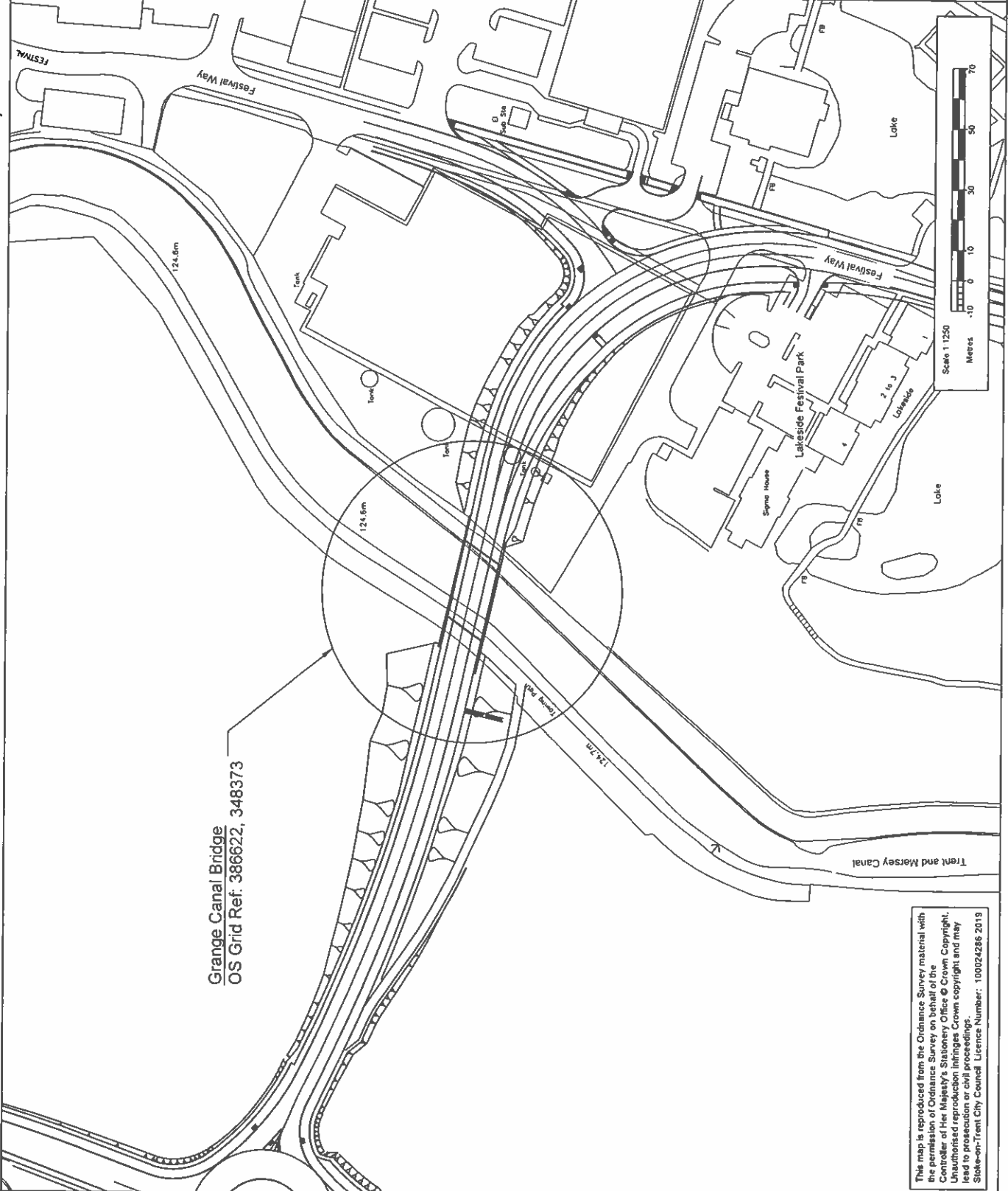

This map is reproduced from the Ordnance Survey material with the permission of Ordnance Survey on behalf of the Controller of Her Majesty's Stationery Office © Crown Copyright. Unauthorised reproduction infringes Crown copyright and may lead to prosecution civil or criminal proceedings.
Stoke-on-Trent City Council Licence Number: 100024285 2019

THE STOKE-ON-TRENT CITY COUNCIL (GRANGE CANAL BRIDGE) SCHEME 2020

ORDERS UNDER SECTION 106 OF THE HIGHWAYS ACT 1980

PLAN NOTES

This map is reproduced from the Ordnance Survey material with the permission of Ordnance Survey on behalf of the Controller of Her Majesty's Stationery Office © Crown Copyright. It is reproduced in this document in accordance with the provisions of the Ordnance Survey Act 2003 and may be used for any purpose not prohibited by the Act.

SCALE: AS SHOWN

THE STOKE-ON-TRENT CITY COUNCIL
(GRANGE CANAL BRIDGE) SCHEME 2020

Drawing No. 70058503/QDBO/0002

TYPICAL CROSS-SECTION
AND ELEVATION PLAN

